

Hex Rod Coupler Nut

Thread Type: Metric - Coarse

Thread Direction: Right Hand

Material: Stainless Steel

Class Grade: A4-70 G316

Corrosion Protection Level: Ultimate

Standard: DIN 6334

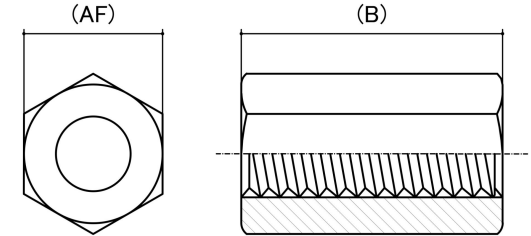

*Cad Drawings shown for graphic representation only.**

Size	Thread Pitch (mm)	Thread Type	Overall Nut Height (B) (mm)	Across Flats (AF) (mm)		Spanner Size (AF) (mm)	sku (Part Number)
			Nom	Min	Max		
M5	0.80mm	Coarse	15.00	7.78	8.00	8mm	41COS5M
M6	1.00mm	Coarse	18.00	9.78	10.00	10mm	41COS6M
M8	1.25mm	Coarse	24.00	12.73	13.00	13mm	41COS8M
M10	1.50mm	Coarse	30.00	16.73	17.00	17mm	41COS10M
M12	1.75mm	Coarse	36.00	18.67	19.00	19mm	41COS12M
M16	2.00mm	Coarse	48.00	23.67	24.00	24mm	41COS16M
M20	2.50mm	Coarse	60.00	29.16	30.00	30mm	41COS20M
M24	3.00mm	Coarse	72.00	35.16	36.00	36mm	41COS24M

Disclaimer:

Dimensional data and technical information was obtained from publically available sources and not acquired through standard agencies. It has been completed and compiled for reference purposes only; where discrepancies are found they are subject to change without notice. Bolt & Nut Australia makes no warranties or representations regarding the accuracy and validity of the compiled information and data. Contact the relevant standard authorities for accurate and detailed information.

* Cad Drawings may not reflect diameter, thread length or overall length.

© Bolt & Nut Australia Pty Ltd. All rights reserved.

Version: 25 Aug 2024